

## SPECIFICATIONS

### Configurations

- Upflow / Horizontal
- Downflow

### Heat Exchanger Design

- Aluminized steel primary heat exchanger with crimped non-welded construction
- AL 29-4c stainless steel secondary heat exchanger

### Burner

- 11k BTUH burners and sealed burner box provide soft ignition and quiet operation

### Cabinet Design

- Compact 33" height
- Standardized widths for easy coil fit

### Air Delivery System

- Multi-speed high efficiency (constant torque) blower motor
- Easily removable slide-out blower design

### Controls

- Single stage gas valve
- Self diagnostics save last 10 fault codes regardless of power interruption
- Durable silicon nitride igniter
- Electronic air cleaner and humidifier terminals

### Venting

- Certified for direct vent and indirect (1 and 2 pipe applications)

### Installation Features

- Left or right gas and utility connection
- Zero step horizontal conversion
- Removable floor base (upflow/horizontal units) for bottom return air



## SINGLE STAGE CONSTANT TORQUE GAS FURNACE

92%



### California Only

*This furnace does not meet the South Coast Air Quality Management District (SCAQMD) Rule 1111 and San Joaquin Valley Air Pollution Control District (SJVAPCD) Rule 4905 NOx emission limit (14 ng/J) and cannot be installed within the SCAQMD or SJVAPCD and Bay Area.*

**Warranty**—20 years on heat exchanger, 6 years on parts  
(Some limitations apply; see printed warranty for details.)

[www.century-hvac.com](http://www.century-hvac.com)

# MODEL NUMBER GUIDE

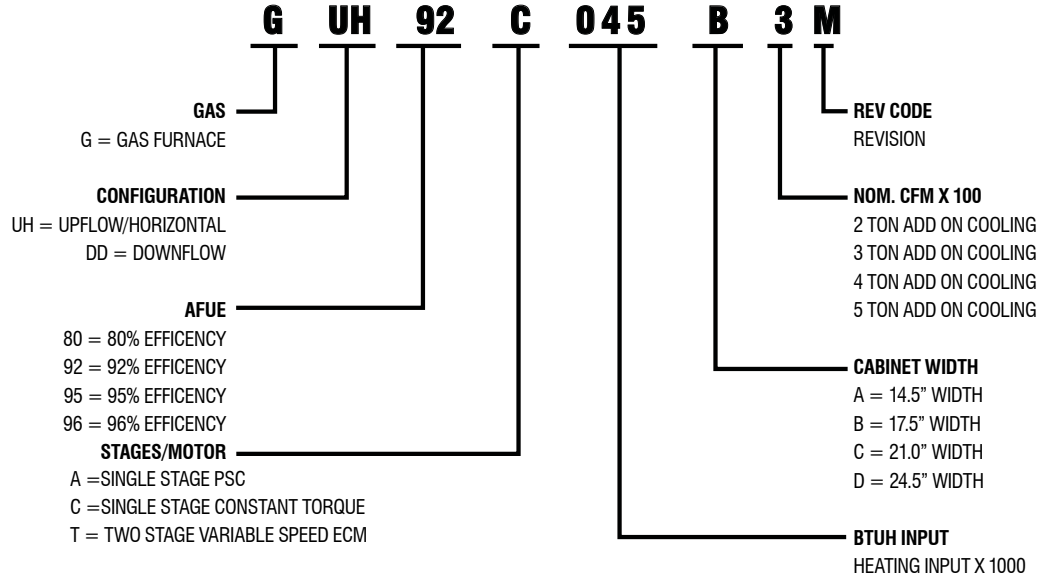

## DIMENSIONS (IN.)

| Model             |              | A      | B      | C      | D       |
|-------------------|--------------|--------|--------|--------|---------|
| UPFLOW/HORIZONTAL | GUH92C045B3M | 17-1/2 | 16-3/8 | 16     | 9-5/16  |
|                   | GUH92C070B3M | 17-1/2 | 16-3/8 | 16     | 9-5/16  |
|                   | GUH92C090C3M | 21     | 19-7/8 | 19-1/2 | 11-5/16 |
|                   | GUH92C090C4M | 21     | 19-7/8 | 19-1/2 | 11-5/16 |
|                   | GUH92C110C4M | 21     | 19-7/8 | 19-1/2 | 11-5/16 |
|                   | GUH92C110C5M | 21     | 19-7/8 | 19-1/2 | 11-5/16 |
| DOWNFLOW          | GDD92C045B3M | 17-1/2 | 16-3/8 | 16     | 15-1/2  |
|                   | GDD92C070B3M | 17-1/2 | 16-3/8 | 16     | 15-1/2  |
|                   | GDD92C090C4M | 21     | 19-7/8 | 19-1/2 | 19      |

**UPFLOW/HORIZONTAL TOP VIEW**

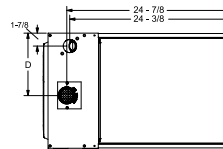

**DOWNFLOW TOP VIEW**

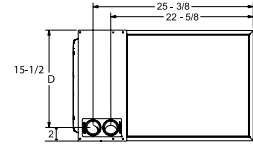

**FRONT VIEW**

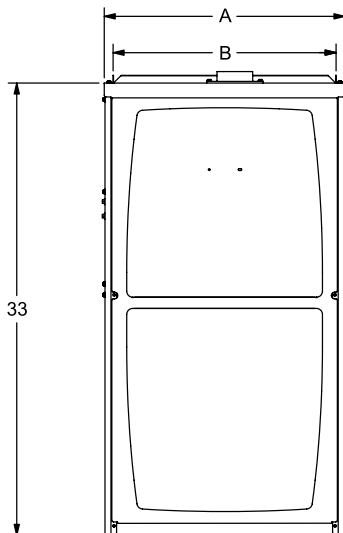

**RIGHT SIDE VIEW**

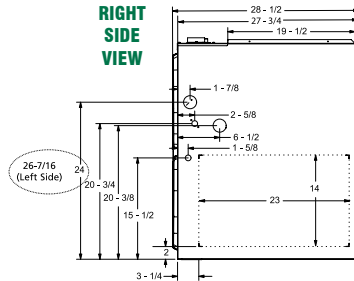

**RIGHT SIDE VIEW**

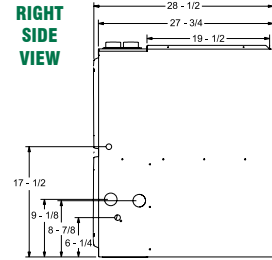

**BOTTOM VIEW**

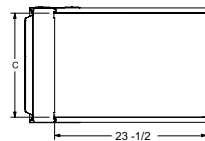

**BOTTOM VIEW**

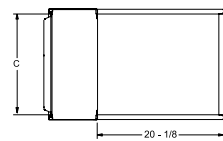

## BLOWER PERFORMANCE DATA

| Model               | Motor Size (hp) | Blower Size | Heating Temp Rise (F°) | Blower Speed | Heating CFM @ .10" - .30" w.c. |      |      |      |      |      |      |      |      |
|---------------------|-----------------|-------------|------------------------|--------------|--------------------------------|------|------|------|------|------|------|------|------|
|                     |                 |             |                        |              | 0.10                           | 0.20 | 0.30 | 0.40 | 0.50 | 0.60 | 0.70 | 0.80 |      |
| UPFLOW / HORIZONTAL | GUH92C045B3M    | 1/2         | 10 x 8                 | 25 - 55      | High                           | 1390 | 1355 | 1330 | 1295 | 1265 | 1240 | 1210 | 1160 |
|                     |                 |             |                        |              | Med/High                       | 1270 | 1230 | 1205 | 1180 | 1140 | 1100 | 1065 | 1030 |
|                     |                 |             |                        |              | Med                            | 1135 | 1100 | 1060 | 1025 | 995  | 955  | 920  | 880  |
|                     |                 |             |                        |              | Med/Low                        | 885  | 850  | 795  | 755  | 720  | 670  | 615  | 580  |
|                     |                 |             |                        |              | Low                            | 735  | 680  | 625  | 570  | 515  | 475  | 425  | 355  |
|                     | GUH92C070B3M    | 1/2         | 10 x 8                 | 40 - 70      | High                           | 1395 | 1365 | 1340 | 1305 | 1270 | 1250 | 1210 | 1185 |
|                     |                 |             |                        |              | Med/High                       | 1270 | 1245 | 1215 | 1180 | 1145 | 1110 | 1080 | 1045 |
|                     |                 |             |                        |              | Med                            | 1145 | 1100 | 1080 | 1040 | 1005 | 970  | 930  | 885  |
|                     |                 |             |                        |              | Med/Low                        | 910  | 865  | 815  | 760  | 720  | 685  | 635  | 600  |
|                     |                 |             |                        |              | Low                            | 705  | 655  | 600  | 550  | 505  | 455  | 405  | 355  |
|                     | GUH92C090C3M    | 1/2         | 10 x 8                 | 50 - 80      | High                           | 1375 | 1340 | 1310 | 1275 | 1450 | 1210 | 1170 | 1135 |
|                     |                 |             |                        |              | Med/High                       | 1315 | 1285 | 1260 | 1225 | 1190 | 1160 | 1130 | 1105 |
|                     |                 |             |                        |              | Med                            | 1125 | 1090 | 1055 | 1015 | 965  | 920  | 885  | 855  |
|                     |                 |             |                        |              | Med/Low                        | 885  | 840  | 780  | 730  | 675  | 620  | 580  | 535  |
|                     |                 |             |                        |              | Low                            | 730  | 685  | 645  | 590  | 535  | 495  | 455  | 405  |
|                     | GUH92C090C4M    | 3/4         | 10 x 10                | 45 - 75      | High                           | 1675 | 1655 | 1615 | 1595 | 1560 | 1525 | 1490 | 1445 |
|                     |                 |             |                        |              | Med/High                       | 1475 | 1460 | 1410 | 1365 | 1335 | 1295 | 1260 | 1230 |
|                     |                 |             |                        |              | Med                            | 1365 | 1315 | 1290 | 1245 | 1200 | 1160 | 1105 | 1085 |
|                     |                 |             |                        |              | Med/Low                        | 1275 | 1230 | 1195 | 1155 | 1105 | 1060 | 1015 | 980  |
|                     |                 |             |                        |              | Low                            | 1160 | 1110 | 1065 | 1010 | 965  | 915  | 875  | 830  |
|                     | GUH92C110C4M    | 3/4         | 10 x 10                | 50 - 80      | High                           | 1715 | 1680 | 1640 | 1615 | 1580 | 1540 | 1515 | 1470 |
|                     |                 |             |                        |              | Med/High                       | 1495 | 1470 | 1425 | 1395 | 1345 | 1315 | 1285 | 1230 |
|                     |                 |             |                        |              | Med                            | 1380 | 1355 | 1300 | 1260 | 1225 | 1180 | 1135 | 1095 |
|                     |                 |             |                        |              | Med/Low                        | 1295 | 1255 | 1220 | 1170 | 1130 | 1080 | 1035 | 995  |
| Low                 |                 |             |                        |              | 1175                           | 1135 | 1085 | 1025 | 975  | 935  | 895  | 850  |      |
| GUH92C110C5M        | 1               | 11 1/2 x 10 | 45 - 75                | High         | 2120                           | 2085 | 2040 | 2005 | 1965 | 1935 | 1885 | 1855 |      |
|                     |                 |             |                        | Med/High     | 1880                           | 1830 | 1795 | 1760 | 1710 | 1680 | 1635 | 1600 |      |
|                     |                 |             |                        | Med          | 1715                           | 1665 | 1630 | 1585 | 1540 | 1510 | 1485 | 1440 |      |
|                     |                 |             |                        | Med/Low      | 1605                           | 1560 | 1515 | 1470 | 1425 | 1390 | 1345 | 1305 |      |
|                     |                 |             |                        | Low          | 1435                           | 1360 | 1325 | 1270 | 1230 | 1180 | 1140 | 1085 |      |
| DOWNFLOW            | GDD92C045B3M    | 1/2         | 10 x 8                 | 25 - 55      | High                           | 1395 | 1365 | 1330 | 1305 | 1275 | 1245 | N/A  | N/A  |
|                     |                 |             |                        |              | Med/High                       | 1270 | 1245 | 1215 | 1180 | 1140 | 1110 | 1080 | 1030 |
|                     |                 |             |                        |              | Med                            | 1145 | 1105 | 1070 | 1025 | 980  | 950  | 910  | 870  |
|                     |                 |             |                        |              | Med/Low                        | 845  | 795  | 740  | 700  | 660  | 615  | 585  | 545  |
|                     |                 |             |                        |              | Low                            | 695  | 640  | 575  | 530  | 485  | 445  | 390  | 335  |
|                     | GDD92C070B3M    | 1/2         | 10 x 8                 | 40 - 70      | High                           | 1380 | 1345 | 1325 | 1295 | 1260 | 1235 | 1185 | N/A  |
|                     |                 |             |                        |              | Med/High                       | 1265 | 1240 | 1215 | 1175 | 1135 | 1105 | 1080 | 1040 |
|                     |                 |             |                        |              | Med                            | 1140 | 1090 | 1060 | 1025 | 985  | 955  | 910  | 865  |
|                     |                 |             |                        |              | Med/Low                        | 860  | 810  | 770  | 710  | 670  | 620  | 585  | 540  |
|                     |                 |             |                        |              | Low                            | 700  | 645  | 590  | 530  | 490  | 440  | 395  | 340  |
|                     | GDD92C090C4M    | 3/4         | 10 x 10                | 45 - 75      | High                           | 1695 | 1680 | 1640 | 1605 | 1575 | 1550 | 1490 | N/A  |
|                     |                 |             |                        |              | Med/High                       | 1495 | 1445 | 1410 | 1385 | 1355 | 1310 | 1265 | 1240 |
| Med                 |                 |             |                        |              | 1365                           | 1315 | 1285 | 1245 | 1215 | 1165 | 1125 | 1075 |      |
| Med/Low             |                 |             |                        |              | 1265                           | 1240 | 1200 | 1160 | 1115 | 1085 | 1030 | 995  |      |
| Low                 |                 |             |                        |              | 1160                           | 1110 | 1070 | 1020 | 675  | 625  | 885  | 825  |      |

## PHYSICAL AND ELECTRICAL DATA

| Model               | Input (Btuh) | Output * (Btuh) | AFUE (ICS) | Nominal* Cooling Capacity (tons) | Gas Inlet (in.) | Volts/ Hertz/ Phase | Max. Time Delay Breaker or Fuse | Nominal F.L.A. | Trans. (V.A.) | Approx. Shipping Weight (lbs.) |       |
|---------------------|--------------|-----------------|------------|----------------------------------|-----------------|---------------------|---------------------------------|----------------|---------------|--------------------------------|-------|
| UPFLOW / HORIZONTAL | GUH92C045B3M | 44,000          | 42,000     | 92.1%                            | 1.5-3           | 1/2                 | 120-60-1                        | 15             | 6.8           | 40                             | 121.5 |
|                     | GUH92C070B3M | 66,000          | 63,000     | 92.1%                            | 1.5-3           | 1/2                 | 120-60-1                        | 15             | 6.8           | 40                             | 128.5 |
|                     | GUH92C090C3M | 88,000          | 84,000     | 92.1%                            | 1.5-3           | 1/2                 | 120-60-1                        | 15             | 6.8           | 40                             | 145.0 |
|                     | GUH92C090C4M | 88,000          | 84,000     | 92.1%                            | 2.5-4           | 1/2                 | 120-60-1                        | 15             | 8.4           | 40                             | 145.0 |
|                     | GUH92C110C4M | 110,000         | 104,000    | 92.1%                            | 2.5-4           | 1/2                 | 120-60-1                        | 15             | 8.4           | 40                             | 157.0 |
|                     | GUH92C110C5M | 110,000         | 105,000    | 92.1%                            | 3-5             | 1/2                 | 120-60-1                        | 15             | 10.9          | 40                             | 159.0 |
| DOWNFLOW            | GDD92C045B3M | 44,000          | 42,000     | 92.1%                            | 1.5-3           | 1/2                 | 120-60-1                        | 15             | 6.8           | 40                             | 123.5 |
|                     | GDD92C070B3M | 66,000          | 63,000     | 92.1%                            | 1.5-3           | 1/2                 | 120-60-1                        | 15             | 6.8           | 40                             | 129.5 |
|                     | GDD92C090C4M | 88,000          | 84,000     | 92.1%                            | 2.5-4           | 1/2                 | 120-60-1                        | 15             | 8.4           | 40                             | 152.0 |

Note: For vent length and clearances to combustibles, please reference installation instructions.

\* At full capacity

## ACCESSORY LIST

| CATALOG NUMBER   | DESCRIPTION                              |
|--|--|
| <b>External Filter Rack Kits</b>                           |  |
| 1.841018   | 1 pack (16 x 25)                         |
| 1.841039   | 10 pack (16 x 25)                        |
| <b>Natural to LP Kits</b>                                  |  |
| 11K50  | 1-Stage GUH/GDD92C                       |
| 11K45  | High Altitude 1-Stage >7500'             |
| <b>Return Air Base</b>                                     |  |
| 68W62  | 17.5" B Width                            |
| 68W63  | 21.0" C Width                            |
| <b>Night Service Kits</b>                                  |  |
| 18F15  | Single-Stage                             |
| <b>Horizontal Suspension Kit</b>                           |  |
| 51W10  | 80% & 90% Kit                            |
| <b>Flush Mount Termination (90% Furnaces only) US Only</b> |  |
| 51W11  | 2" & 3" Vent Version                     |
| <b>Concentric Vent Kit (90% Furnaces only) US Only</b>     |  |
| 71M80  | 1-1/2" Vent Version                      |
| 69M29  | 2" Vent Version                          |
| 60L46  | 3" Vent Version                          |
| <b>2-Stage Compressor Kit</b>                              |  |
| 85W66  | Blower Relay Kit                         |
| <b>Twinning Kit</b>  |  |
| 16W72  | Constant Torque Gas Furnace Twinning Kit |
| <b>Twinning Kit</b>  |  |
| 16W72  | Constant Torque Gas Furnace Twinning Kit |

For vent length and clearances to combustibles, please reference installation instructions.

"This product complies with all California product labeling laws including, but not limited to, the Safe Drinking Water and Toxic Enforcement Act of 1986, more commonly known as Proposition 65."

*Due to ongoing product improvements, specifications and dimensions are subject to change and correction without notice or incurring obligations. Determining the application and suitability for use of any product is the responsibility of the installer. Additionally, the installer is responsible for verifying dimensional data on the actual product prior to beginning any installation preparations. Third party incentive and rebate programs have precise requirements as to product performance and certification. All products meet applicable regulations in effect on date of manufacture; however, certifications are not necessarily granted for the life of a product. Therefore, it is the responsibility of the applicant to determine whether a specific model qualifies for these incentive/rebate programs.*